

PARTS BOOK

FOR

brother® Overlock Sewing Machine

MODEL 920D/934D

From the library of Diamond Needle Corp

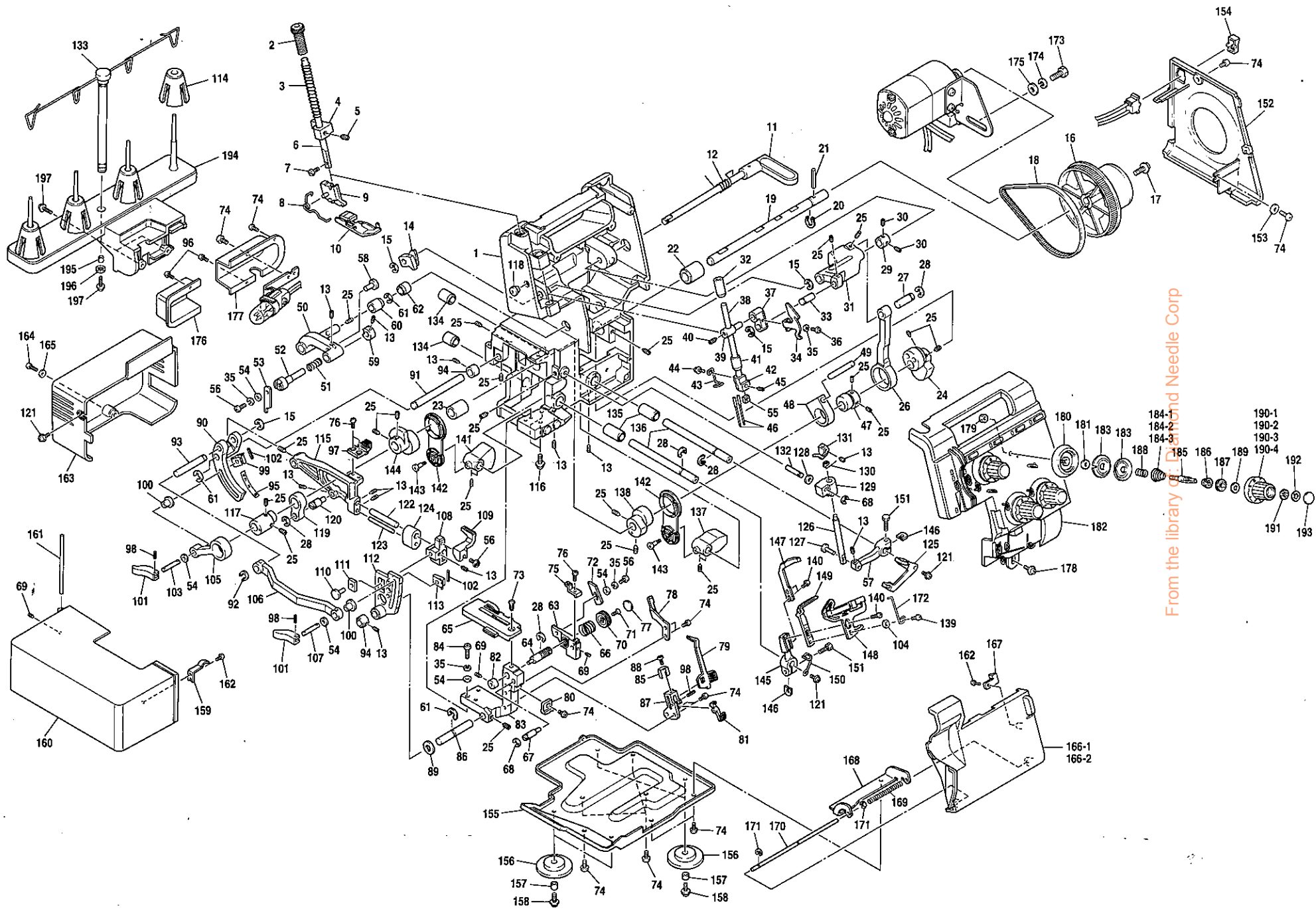

From the library of: **Diamond Needle Corp**

| Ref. No. | Parts No. | Parts Name | Ref. No. | Parts No. | Parts Name | Ref. No. | Parts No. | Parts Name | Ref. No. | Parts No. | Parts Name |
|----------|------------|---------------------------------|----------|------------|-------------------------------|----------|------------|--|----------|------------|--|
| 1 | X77040-001 | Machine body | 61 | 048070-342 | Stop ring | 121 | X75721-001 | Set screw | 180 | X75618-001 | Tension bracket |
| 2 | 142860-001 | Presser adjusting screw | 62 | 126594-000 | Driving arm bushing, right | 122 | 138868-001 | Main feed bar shaft | 181 | 025050-132 | Washer |
| 3 | 126662-001 | Presser bar spring | 63 | X77121-000 | Lower knife holder | 123 | 138869-001 | Differential feed guide shaft | 182 | X77221-001 | Panel assembly |
| 4 | 127198-000 | Presser bar guide bracket | 64 | X77122-001 | Lower knife control shaft | 124 | X05041-000 | Sponge | 183 | X75717-001 | Tension disc |
| 5 | 100058-003 | Set screw | 65 | X77087-001 | Needle plate | 125 | X77180-001 | Looper thread take-up A | 184-1 | X07341-001 | Needle tension spring H |
| 6 | 126660-001 | Presser bar | 66 | X77126-001 | Lower knife control spring | 126 | 127786-001 | Upperlooper shaft | 184-2 | 127849-001 | Upperlooper tension spring |
| 7 | 126851-001 | Set screw | 67 | X77125-001 | Holder guide shaft | 127 | 127785-001 | Upperlooper stud shaft | 184-3 | 127850-001 | Lowerlooper tension spring |
| 8 | X76602-001 | Presser foot spring | 68 | 048040-342 | Stop ring | 128 | 025710-235 | Washer | 185 | X05012-000 | Tension control stud |
| 9 | X76600-001 | Presser holder assembly | 69 | 014300-332 | Set screw | 129 | X76766-001 | Upperlooper shaft guide | 186 | X75051-000 | Tension spring washer |
| 10 | X76606-001 | Presser foot assembly | 70 | X77123-001 | Lower knife control knob | 130 | X75971-001 | Upperlooper thread guide | 187 | X05015-000 | Dial ratchet |
| 11 | 138877-006 | Presser bar lifter | 71 | 061400-805 | Machine screw | 131 | X75209-001 | Upperlooper | 188 | X75883-001 | Tension spring S |
| 12 | X77096-001 | Spring | 72 | X05007-001 | Lower knife | 132 | 127784-001 | Guide shaft | 189 | 025710-235 | Washer |
| 13 | 014400-422 | Set screw | 73 | 100032-003 | Set screw | 133 | X77184-001 | Spool stand assembly | 190-1 | X75910-001 | Needle tension dial, left |
| 14 | 138879-000 | Presser lifter cam | 74 | 060400-606 | Set screw | 134 | 126611-000 | Looper lever bushing, back | 190-2 | X75910-002 | Needle tension dial, right |
| 15 | 048050-346 | Stop ring | 75 | X77127-001 | Needle guard | 135 | 126610-000 | Looper lever bushing, front | 190-3 | X75910-003 | Upperlooper tension dial |
| 16 | 127830-005 | Timing pulley | 76 | 060300-616 | Set screw | 136 | X76339-000 | Looper lever shaft | 190-4 | X75910-004 | Lowerlooper tension dial |
| 17 | X76398-001 | Set screw | 77 | X77124-001 | Knife dial seal | 137 | X77145-000 | Upperlooper balance | 191 | X75729-001 | Spring washer |
| 18 | 126533-001 | Timing belt | 78 | X77095-001 | Fixed needle guard | 138 | X77144-000 | Upperlooper eccentric wheel | 192 | 138384-001 | Stop ring |
| 19 | 127789-000 | Driving shaft | 79 | X77094-001 | Stitch tongue | 139 | 062670-312 | Set screw | 193 | X75627-001 | Tension dial plate |
| 20 | 048100-142 | Stop ring | 80 | X77055-001 | Cloth plate cover stopper | 140 | 062670-612 | Set screw | 194 | X77183-001 | Spool stand base |
| 21 | 047402-542 | Spring pin | 81 | X77093-000 | Stitch finger release lever | 141 | X77150-000 | Lowerlooper balance | 195 | X76930-001 | Spacer |
| 22 | 126558-000 | Driving shaft bushing, right | 82 | X76230-001 | Thread tension release block | 142 | X76391-001 | Double chain looper rod | 196 | X76931-001 | Spring washer |
| 23 | 127690-000 | Driving shaft bushing, left | 83 | X77049-000 | Needle plate base | 143 | X75317-001 | Stud screw | 197 | X75770-001 | Set screw |
| 24 | X77081-000 | Needle bar eccentric wheel | 84 | 062402-005 | Set screw | 144 | X77149-000 | Lowerlooper eccentric wheel | | | |
| 25 | 012500-632 | Set screw | 85 | X77092-001 | Stitch plate spring | 145 | X05077-001 | Lowerlooper lever | | | |
| 26 | 138839-000 | Needle bar rod | 86 | X77110-001 | Differential feed lever shaft | 146 | X05281-001 | Washer | | X77228-001 | Motor (110/120V area) |
| 27 | 138875-001 | Rod shaft | 87 | X77091-000 | Stitch holder | 147 | X75388-001 | Movable needle guard B | | X77233-001 | Motor (Canada) |
| 28 | 048060-342 | Stop ring | 88 | 062300-406 | Set screw | 148 | X77137-001 | Lowerlooper thread through-feed assembly | | X77308-001 | Motor (220V area) |
| 29 | X05286-001 | Driving arm bushing | 89 | 025080-132 | Washer | 149 | X77340-001 | Lowerlooper | | X77222-001 | Motor (230V area) |
| 30 | 014400-332 | Set screw | 90 | X77103-001 | Feed bar lever | 150 | X77207-000 | Looper thread take-up B | | X77247-001 | Motor (U.K., Australia, New Zealand) |
| 31 | X77084-000 | Needle bar driving lever | 91 | X75080-001 | Driving lever shaft | 151 | 017501-615 | Set screw | | X77250-001 | Motor (dual voltage) |
| 32 | 126702-000 | Needle bar bushing, upper | 92 | 048070-142 | Stop ring | 152 | X77056-001 | Belt cover | | | |
| 33 | 138876-001 | Needle bar rod shaft | 93 | X77104-001 | Feed bar shaft | 153 | 025040-332 | Washer | | J01780-051 | Foot controller (110/120V area) |
| 34 | X77085-001 | Thread take-up | 94 | X75150-001 | Collar | 154 | X75554-051 | PW switch key-top | | J01434-051 | Foot controller (Canada) |
| 35 | 028040-242 | Spring washer | 95 | X77214-001 | Feed pitch scale plate | 155 | X77048-001 | Oil pan | | J01590-051 | Foot controller (220/230V area) |
| 36 | 060670-812 | Set screw | 96 | 062300-604 | Set screw | 156 | X75545-000 | Cushion A | | J01664-051 | Foot controller (U.K.) |
| 37 | 126782-001 | Needle bar connecting link A | 97 | X77105-001 | Main feed dog | 157 | X75546-000 | Spacer | | J01665-051 | Foot controller (Australia, New Zealand) |
| 38 | X75650-001 | Needle bar | 98 | 047200-842 | Spring pin | 158 | X75720-001 | Set screw | | J02127-051 | Foot controller (dual voltage) |
| 39 | 126656-001 | Needle bar connecting stud | 99 | 127558-001 | Spring | 159 | X77052-001 | Cloth plate cover spring | | | |
| 40 | 014060-632 | Set screw | 100 | X05008-001 | Feed link bushing | 160 | X77241-001 | Cloth plate cover assembly | | | |
| 41 | 126703-000 | Needle bar bushing, lower | 101 | 127559-000 | Feed adjusting cam | 161 | X77054-001 | Hinge pin | | 126736-001 | Soft cover |
| 42 | X75205-001 | Needle clamp | 102 | 047201-442 | Spring pin | 162 | 037300-815 | Set screw | | 122991-002 | Accessory bag |
| 43 | X75972-001 | Needle bar thread guide | 103 | X05001-001 | Feed adjusting shaft | 163 | X77057-001 | Motor cover | | X75902-001 | Tweezers |
| 44 | X76215-001 | Set screw | 104 | 025350-132 | Washer | 164 | 062401-206 | Set screw | | X75904-000 | Thread net |
| 45 | 016400-632 | Set screw | 105 | X77102-000 | Feed link | 165 | 126850-000 | Washer | | X77260-000 | Thread spool cap |
| 46 | X75577-014 | Needle #90 | 106 | X77107-000 | Differential feed link | 166-1 | X77202-001 | Front cover (934D) | | X75437-001 | Screw driver (small) |
| 47 | X77113-000 | Upper knife eccentric wheel | 107 | 127560-001 | Feed adjusting shaft | 166-2 | X77369-001 | Front cover (920D) | | X75917-001 | Needle set (#80/#90) |
| 48 | 127795-000 | Upper knife driving lever guide | 108 | X77106-000 | Differential feed bar | 167 | X75632-001 | Front cover hook | | X75906-001 | Cleaning brush |
| 49 | 127805-001 | Upper knife driving lever | 109 | 138895-001 | Differential feed dog | 168 | X77044-001 | Front cover hinge plate | | X77128-001 | Hexagonal (allen) wrench |
| 50 | X77116-001 | Upper knife driving arm | 110 | 138867-001 | Guide shaft | 169 | 126519-000 | Front cover spring | | X55468-051 | Screw driver (large) |
| 51 | X77118-001 | Upper knife presser spring | 111 | X77111-000 | Slide block | 170 | X77045-001 | Front cover guide shaft | | X77283-001 | Trim trap |
| 52 | X77117-001 | Upper knife holder | 112 | X77108-000 | Driving control lever | 171 | 048020-346 | Stop ring | | X76590-002 | Blind stitch foot |
| 53 | X77119-001 | Upper knife | 113 | X77109-001 | Driving control spring | 172 | X75984-001 | Lowerlooper screw cover | | X76663-001 | Elastic taping foot |
| 54 | 025040-232 | Washer | 114 | 126863-002 | Spool cushion | 173 | 103741-001 | Set screw | | X76670-002 | Pearl sequence foot |
| 55 | X75246-001 | Nut | 115 | X77099-000 | Main feed bar | 174 | 203735-001 | Spring washer | | X76668-002 | Piping foot |
| 56 | 060400-812 | Set screw | 116 | X77265-001 | Set screw | 175 | 100197-004 | Washer | | | |
| 57 | X77132-001 | Upperlooper shaft lever | 117 | X77101-000 | Feed eccentric wheel | 176 | X77239-001 | Rear cover | | | |
| 58 | 127656-001 | Upper knife holder guide shaft | 118 | 114255-003 | Cap | 177 | X77063-001 | Lamp cover | | | |
| 59 | 127669-001 | Upper knife holder guide | 119 | 126872-000 | Vertical feed lever | 178 | X75721-001 | Set screw | | | |
| 60 | 126595-000 | Driving arm bushing, left | 120 | 127801-001 | Vertical adjusting shaft | 179 | 021500-106 | Set screw | | | |

From the library of: Diamond Needle Corp